

PROPOSAL



St. Mark Catholic Church Playground and Pavilion



Submitted Jointly by the
Facilities and Projects Committee
and
The Development Council

February 19, 2009



Proposal
St. Mark Playground and Pavilion
Submitted Jointly by the Facilities and Projects Committee and
The Development Council

February 19th, 2009

History: Over the past two years the Facilities and Projects Committee has been researching, discussing and designing and redesigning playground and pavilion facilities for St. Mark. The need to explore these types of facilities was prompted by the amount of land St. Mark had available and the fact that we were holding events off the grounds of St. Mark that could have been done here at St. Mark if we had the facilities to accommodate these events. The Knights of Columbus would not need to leave the grounds for their summer activities. Children could play safely while parents socialized with friends after Mass.

We have looked at the master site plan so that the location of a pavilion and playground would not interfere if any new building took place. We have looked at the cost and have scaled down the design to a basic Pavilion structure and a well designed, safe, certified playground design. The needs that this can serve are described below.

Once the F&P Committee agreed on a plan design, the plan was presented to the Development Council as a fund raising project, the Development Council agreed to develop a plan to raise the funds necessary to accomplish this. The details of this will be discussed at the March meeting of the DC. But it was agreed that the construction of the Pavilion and the Playground would not be started until the funds are raised.

Having covered the planning and design through facilities and Projects and the funding of the project through the Development Council, we are now prepared to present the proposal to the Pastoral Council for its consideration and Fr. John and Bridget for approval to proceed.

Your consideration of this proposal would be appreciated.
Thank you.

Purpose: St. Mark is a young vibrant community with many children. Currently there are no gathering or recreation facilities for our families on the St. Mark grounds. We have significant land assets that are being under utilized. A play ground with a pavilion will provide St. Mark parishioners with an opportunity to gather in fellowship and grow closer as a community. This will be an outdoor extension of our church, where we can enjoy the beautiful Colorado climate.

Demographics: St. Mark has the following young family demographics:

- Percentage of families with children under the age of 12 = 50% (492 / 972)
- Number of children under the age of 12 = 877
- Percentage of families that participate in onsite parish BBQ = > 20%

Benefits and uses:

During the research and discussion of these facilities, a list of possible uses was developed. We feel that these represent some, but not all of the possible uses for these facilities:

- Beer and Brats Event (K of C)

- Annual Celebration of St. Mark Day
- Arts and Crafts shows
- Garage Sales
- Outdoor Dances (Polka and Square Dance Festivals!)
- Summer time family and religious movies
- Outdoor lectures
- St. Francis Day Animal Blessing
- Ministry sponsored social events
- Summertime Gatherer's Dinners
- Outdoor recreation for our children (burn off the donut energy)
- Outdoor Mass, liturgy, and religious education opportunities
- Parish BBQs
- Family ad hoc BBQ
- Summer wedding receptions
- Other summer receptions
- Farmer's Market
- Parish Flea Market
- General gathering after Mass during the summer

Proposed Environment:

- Playground (examples provided in the pre-submittal review below)
 - 40 x 88 fenced in play ground area
 - American Disability Approved play ground equipment to accommodate 25 – 50 children
 - 6 swings (4 child, 2 toddler)
- Pavilion details:
 - 30' x 60' concrete slab and
 - Beam and truss structure
 - Heavy duty fabric roof covering
 - With picnic tables, area can accommodate approximately 150-200 people

Cost:

- Estimated play ground cost = \$50,000 (K of C to provide installation labor)
- Estimated pavilion cost = \$28,000
- Both projects would require involvement of supervised parish labor

Funding:

- \$17,000 of the funding is coming from St. Mark's portion of the Diocese's Returning God's Gifts Campaign from 2008. (Commitment made by Fr. Larry and honored by Fr. John.)
- \$61,000 remaining to be raised by Development Council of St. Mark.
- This Project could be completed in two parts, if necessary: Play ground – Phase I, Pavilion – Phase II.
- Development Council will work on the details of the fund raising effort and submit it to the St. Mark Administration for approval, per the St. Mark Fund Raising Policy.

Timeframe and Plan:

Playground

- Pre-submittal to Douglas County – Completed October 2008
- Highlands Ranch Review – submitted and pending
- Douglas County final review – takes 4 – 6 weeks after HRCA review
- Procure supplies and equipment 2 – 3 weeks
- Certified play ground equipment installation = 2 days
- Fence and border installation = 2 days
- Play ground chip installation = 1 day
- Total time from project green light = 8 - 10 weeks

Pavilion

- **Estimated time of construction 3-4 weeks**

Operational Policies for Pavilion and Playground

- We would ask the Parish administration to develop and promulgate guidelines and policies for the safe use and maintenance of both areas. These policies/guidelines would be consistent with our insurance requirements and safety of the users. It would also clearly outline the responsibilities of the user as to any restrictions of noise, alcohol use, and clean up.

Planned Playground and Pavilion Site Location:

- **See site drawing attached**
- **See playground equipment attached**
- **See Douglas County Review application.**

Conclusion:

We, the members of the Facilities and Projects and Committee and the Development Council feel that due diligence has been given to the development of this proposal. It is consistent with the Mission of St. Mark and the Mission Statement of the facilities and Projects Committee. (See attachment). We feel that your favorable consideration of our proposal will provide our St. Mark Family with an additional resource on which to foster our family spirit as well as enhance our ability to do community outreach.

Thank you for your consideration.

Stan Banaszak

Stanley Banaszak
Servant Leader
Facilities and Projects Committee

St. Mark
Facilities and Projects Committee
Mission and Vision Statements

Final Revision and Adoption – 4-12-07

Mission

In harmony with the Mission of St. Mark Catholic Church, the mission of the St. Mark Facilities and Projects Committee is to enhance the facilities and grounds of St. Mark Parish in a systematic and organized manner, within the scope of the evolving master plan, so that the St. Mark parish family will have a Christ-centered environment most conducive to enriching the worship experience, advancing community outreach and promoting parish activities.

Vision

The Vision of the St. Mark Facilities and Projects Committee is to approach ideas and projects which are presented in an objective and systematic manner, to determine if the idea or project is consistent with the mission of St. Mark Catholic Church and is in the best interest of our parish spiritually and/or financially. The five steps in the approach would include the following:

- **Identify a need or verify that a need exists.**
- **Analyze the request or the identified need thoroughly and objectively.**
- **If the need has been confirmed and it is consistent with the mission of St. Mark, develop a strategy to meet the need.**
- **Present Recommendations and supporting data to our Pastor.**
- **If approved, manage the project to its completion or implementation. (This could include involvement of appropriate ministries or parish committees)**

Both the Mission and the Vision of the St. Mark Facilities and Projects Committee are intended to promulgate a process that will apply sound judgment and analysis to ideas placed before it, regardless of the individual or source providing the idea or project. In so doing, it is our vision to provide our Pastor with recommendations and supporting analysis of these ideas and projects that will allow him to make informed final decisions.

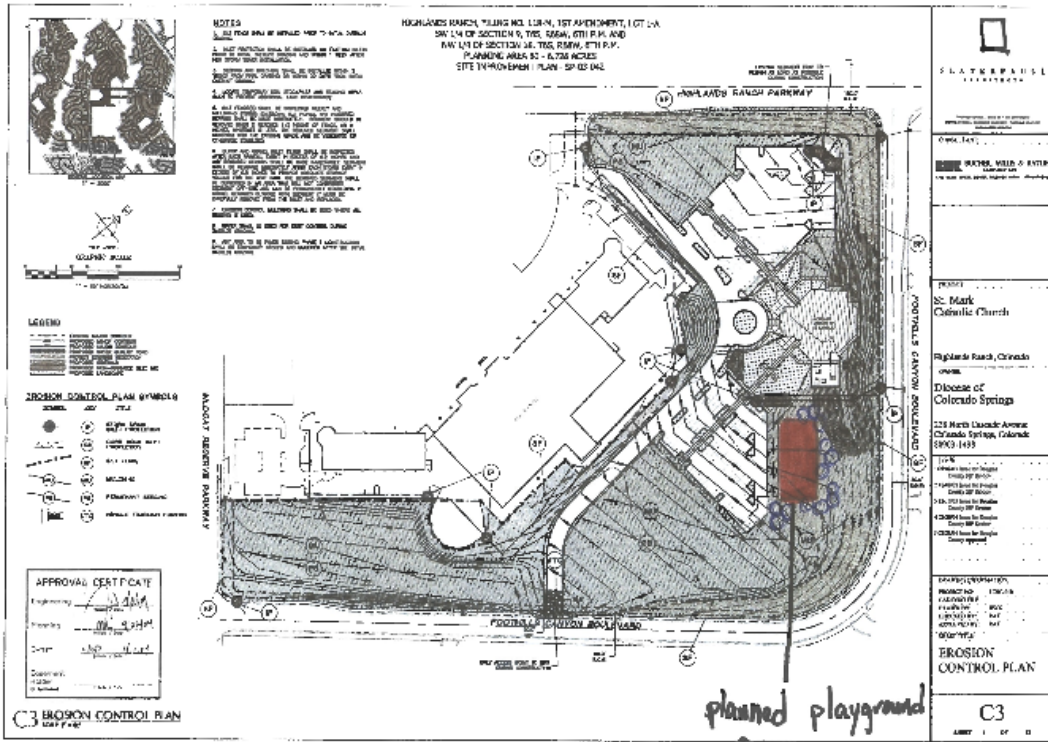

PRESUBMITTAL REVIEW REQUEST

- The presubmittal review is the preliminary review of a land use proposal. Presubmittal reviews are required prior to beginning the application process; ***however, this review is not an application.***
- Presubmittal reviews are internal staff reviews held every Thursday in conjunction with the Building and Engineering Divisions. It is not necessary for the applicant to be present for the review; however, a limited number of face to face meetings may be scheduled. To be on the presubmittal agenda the request and required checklist items must be received **1 week** prior to the review date.
- The *Property Information* required below can be found on the Douglas County Assessor website at www.douglas.co.us/assessor/. Please print a copy of the Assessor’s page and submit it with your presubmittal review request.
- Mail, fax or drop off the request and required checklist items to the address listed below.
- Submitting your request in a timely manner is important to get your project scheduled for review.
- **In most cases, presubmittal review comments and an application submittal packet will be provided to the applicant within one week of the presubmittal review. *The application submittal packet should be used as a guide to complete the application, which is the next step in the development review process.***

Contact Information:

Name: St. Mark Catholic Church – Chris O’Reilly	
Phone: 303.470.3525	Fax:
Email: choreilly@comcast.net	
Project Description: Playground on church grounds	

Property Information:

Section-Township - Range	Section 9 Township 6 Range 68	Zoning and Planning Area	
State Parcel Number	2229-093-17-005	Acreage	6.726
General Location	9905 Foothills Canyon Blvd	Water Source	
Legal Description	Lot 1A Highlands Ranch 118M 1 st AMD 6.726 AM/L	Sewer	
Owner Name	The Diocese of Colorado Springs		

<p><i>Office Use Only</i></p> <p><i>Project Title:</i></p> <p><i>Description:</i></p> <p><i>Review Date:</i></p>	<p><i>Meeting Date/Time:</i></p>
--	----------------------------------

PLEASE PROVIDE THE FOLLOWING ITEMS:

To view Douglas County Regulations, please go to www.douglas.co.us, and select County Departments, Community Development, Plan/Regulations/Documents and the corresponding Resolution, which is listed next to project type below.

FOR SITE IMPROVEMENT PLANS OR USE BY SPECIAL REVIEW: Zoning Resolution

- Brief project narrative explaining request
- Conceptual site plan showing all structures, parking, nearby roads, and driveway access
- Existing contours and proposed grades
- Conceptual drainage
- Conceptual building elevations
- Conceptual landscape plan

St. Mark Catholic Church Site Improvement Narrative

St. Mark is a rapidly growing Catholic Church. Our parish is made up of a significant number of young families with children between the ages of 3 – 15. It is our desire to install a commercial grade playground and swing sets that would allow between 25 – 50 children to play at a time. Vendor specific certified installation experts will install the playground. The playground will be enclosed with Douglas County recommended fencing materials and will have a lockable gate. The surface area will be covered using engineered wood chips. St. Mark will be using materials consistent with Highlands Ranch Metro District playground areas. In fact, Metro Districts has provided a list of qualified vendors for us to contact. The area where the playground will be placed is flat and it will not require any improvements such as retaining walls or extra drainage. It is our intention to also improve the area outside the playground fenced area with grass and 2 – 3 picnic tables. The approximate playground area would be 40 feet wide by 88 feet long. The final playground structure, design and color scheme has not been finalized. Our plan is to use environmentally neutral colors such as tan, brown and green. Below are a couple examples of the type of playground equipment we are considering.

Playground Example 1



Playground Example 2

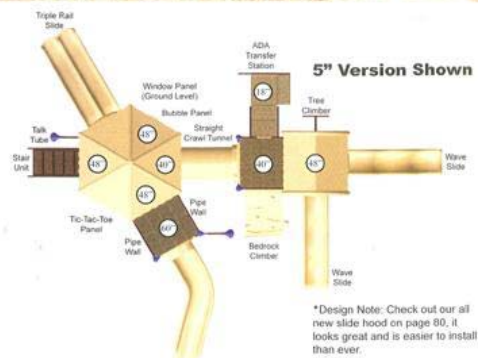

Swings Example

